

Installation Manual

HARDWIRED ROAD STUD

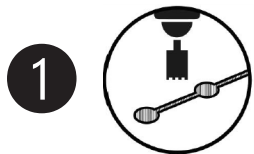

To do the installation Personal Protective Equipment must be worn during all process.



1 Drill Hole

After deciding the location where the stud will be installed, drill a hole with a minimum diameter of 165 mm and 100 mm deep.

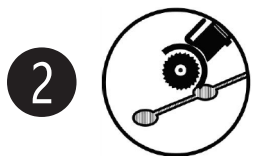

2 Cut Slot

Using a disk cutter, open a connection between the holes with 15 mm width and 60 mm depth. Brush any debris or dust from the hole resulting from drilling.



3 Clean Hole

Brush any debris or dust from the hole resulting from drilling.



4 Dry Hole

Dry the hole with a blowtorch to remove any moisture that may compromise the adhesion and effectiveness of the glue.

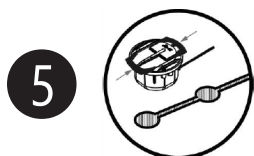

5 Insert Accessory

Apply in each installed that will be installed the SR-SFT4 installation accessory. The accessory will help to align and keep the road stud in place during the glue drying time. This accessory will be removed at the end of the installation



6 Apply Glue & Stud

Pour TRIFLEX CRYL R 238 glue into the hole and insert the stud checking that the LEDs are facing the right way. Remove any excess glue.

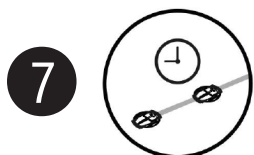

7 Cure & Remove Accessory

The glue drying time may change depending on weather conditions. Consult the glue data sheet for more information. After the glue has dried, the top part of the SR-SFT4 accessory should be broken and removed.



The warranty will not apply if a defect is attributable to failure of following these installation instructions.